

Hotel Meeting Facilities

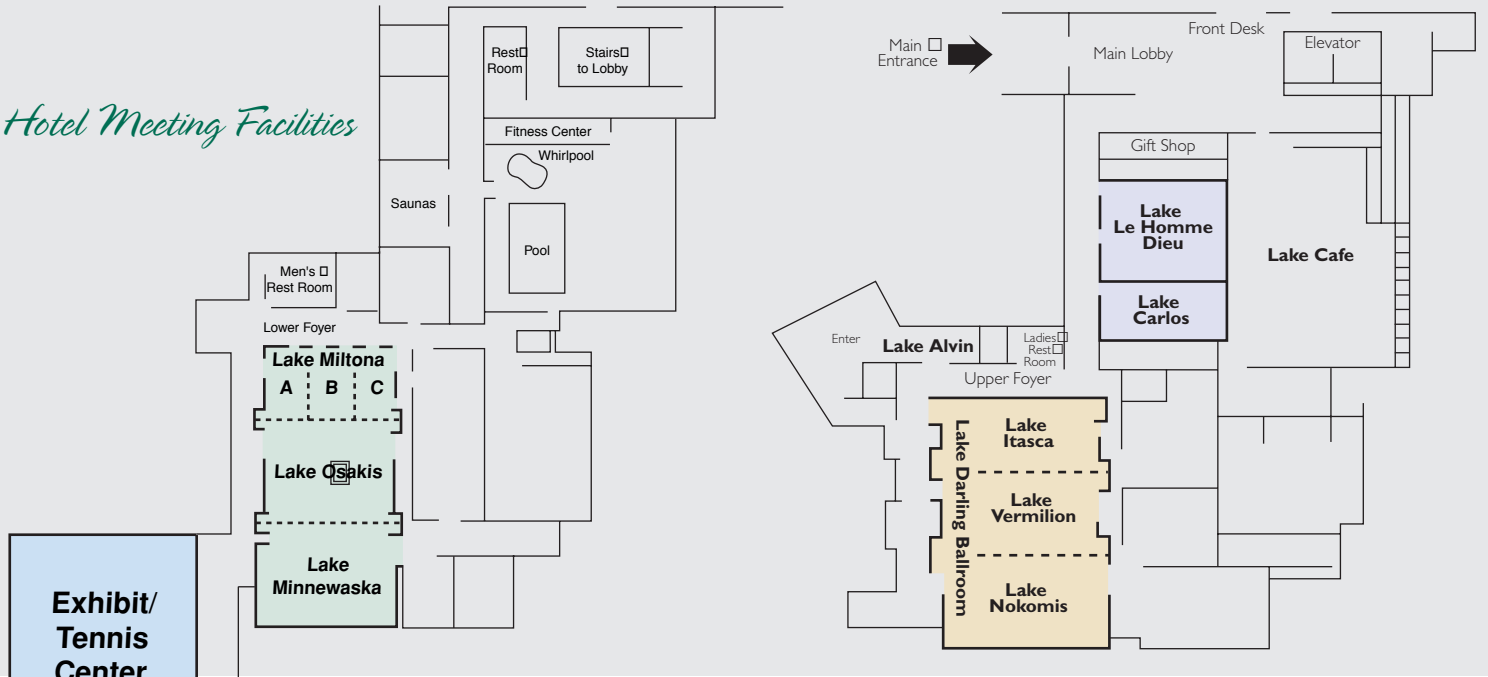

Arrowwood Resort & Conference Center
 2100 Arrowwood Lane NW
 Alexandria, MN 56308
 320-762-1124
www.arrowwoodresort.com

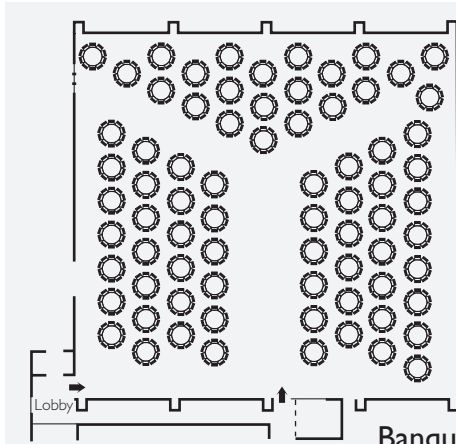

Banquet Set-Up

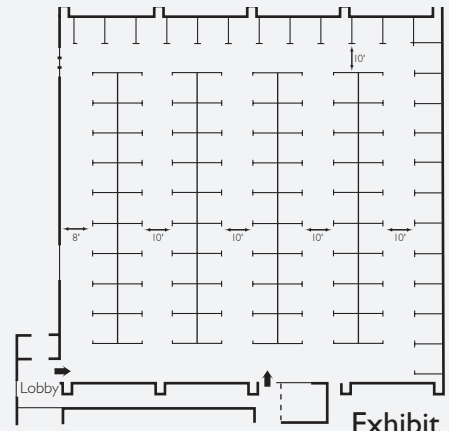

Exhibit Set-Up

Hotel Meeting Facilities

	Room Name	Auditorium	Classroom	Round Tables	Dimensions	Square Footage	Ceiling Height
Lake Darling Ballroom (Upper Level)	Lake Nokomis	225	100	150	31'4" x 56'	1758	15'5"
	Lake Vermilion	225	100	150	32' x 56'	1792	15'5"
	Lake Itasca	225	100	150	31'4" x 56'	1758	15'5"
	Combined Total	675	300	450	95' x 56'	5308	15'5"
	Upper Foyer				14' x 56'	789	8'8"
Lower Conference Center (Lower Level)	Lake Minnewaska	225	100	150	31'4" x 56'	1758	11'0"
	Lake Osakis	225	100	150	32' x 56'	1792	11'0"
	Lake Miltona	225	100	150	31'4" x 56'	1758	11'0"
	A	70	30	30	18'8" x 31'4"	590	11'0"
	B	70	30	30	18'8" x 31'4"	590	11'0"
	C	70	30	30	18'8" x 31'4"	590	11'0"
	Combined Total	675	300	450	95' x 56'	5308	11'0"
Lower Foyer				14' x 56'	784	8'8"	
Meeting Rooms Adjacent to Conference Center	Lake Le Homme Dieu	80	40	50	26' x 32'	832	9'7"
	Lake Carlos	40	20	18	16' x 26'	416	9'7"
Fifth Floor	Executive Board Room I	maximum seating		16 people	15' x 30'	450	9'0"
	Executive Board Room II	maximum seating		16 people	15' x 30'	450	9'0"

Exhibit/Tennis Center

Exhibits	Round Tables	Dimensions	Square Footage
94 - 8' x 10' Booths	750	120' x 120'	14,400